

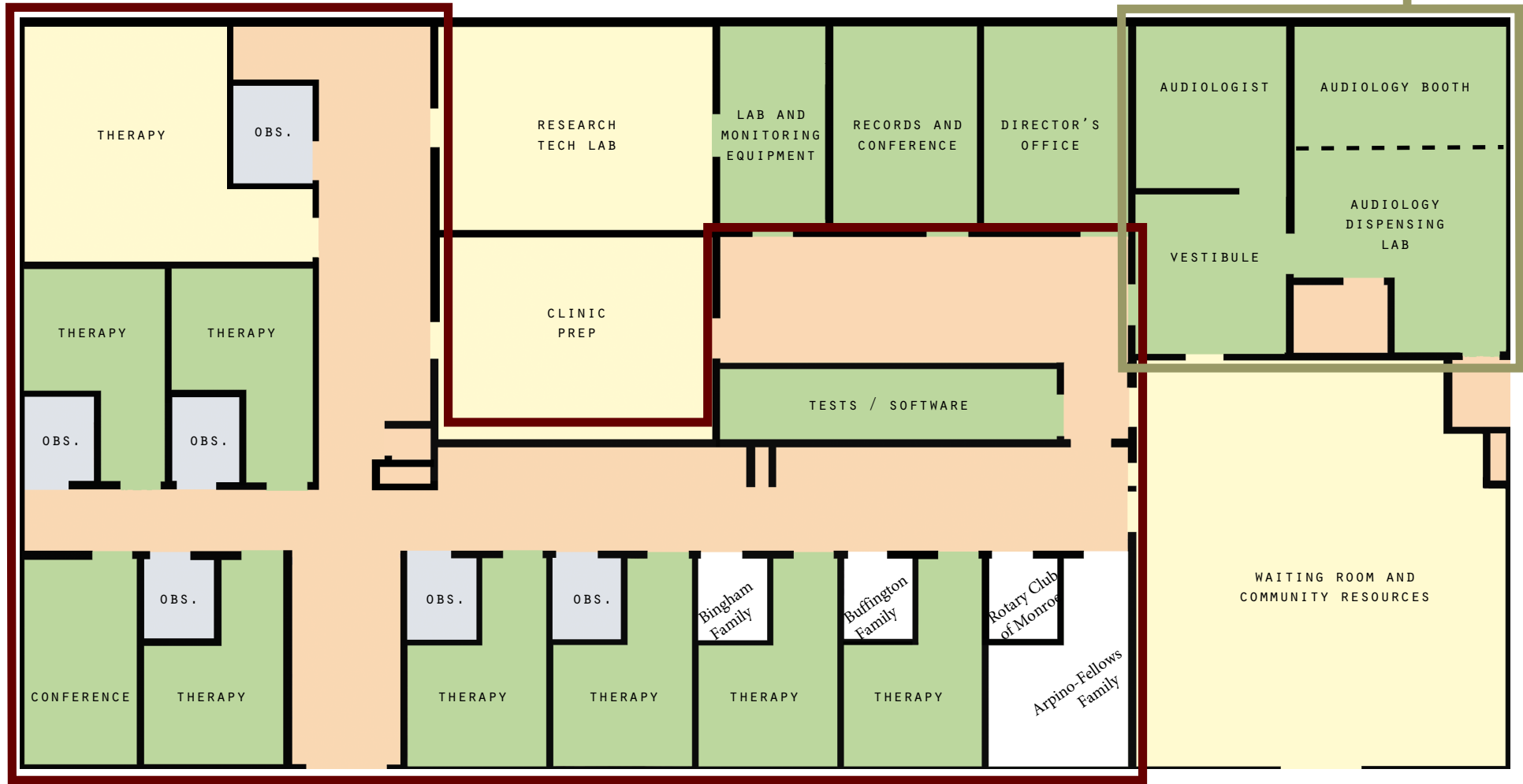

# University of Louisiana Monroe

## Kitty DeGree Speech and Hearing Center

Faye O. Haddox  
Audiology Clinic



Carol Nichols Ray  
Speech - Language  
Pathology Clinic

	Reserved		\$ 10,000
	Reserved		\$ 5,000
	\$25,000		Reserved

as of February 2024